



INSTALLATION INSTRUCTIONS

Universal Voltage (120-277V) LED Luminaire Retrofit Kit

VPR-14-MU-25-9TW-A

VPR-22-MU-25-9TW-A

VPR-24-MU-36-9TW-A

Reference spec sheet for full part numbers

INSTALLATION INSTRUCTIONS

Installation Warnings

- To reduce the risk of death, personal injury, property damage from fire, electric shock, falling parts, cuts/abrasions, and other hazards make sure to read all warnings and instructions included with and on the fixture box and all fixture labels.
- Follow these general precautions before installing, servicing, or performing routine maintenance upon this equipment.
- Commercial installation, service, and maintenance of luminaires should be performed by a qualified licensed electrician.
- LED Retrofit kit installation requires knowledge of luminaires electrical systems. If not qualified, do not attempt installation. Contact a qualified electrician.
- To prevent wiring damage or abrasion, do not expose wiring to edges of sheet metal or other sharp objects.
- Do not make or alter any open holes in an enclosure of wiring or electrical components during kit installation.

Warnings

- Turn off electrical power at fuse or circuit breaker box before wiring fixture to the power supply.
- Turn off the power prior to performing any maintenance
- Verify that the supply voltage is correct by comparing it with the luminaire label information.
- All wiring connections should be capped with UL approved wire connectors.

Risk of fire or electric shock. The electrical rating of these products are 120-277 VAC, the installer must determine whether they have 120-277 V at the luminaire before installation.

Risk of fire or electric shock. Install this kit only in the luminaires that have the construction features and dimensions shown in the photographs and /or drawings.

Risk of fire or electric shock. Luminaire wiring and electrical parts may be damaged when drilling for installation of LED retrofit kit. Check for enclosed wiring and components.

Caution

- Avoid direct eye exposure to the light source while it is on.
- Account for small parts and properly dispose of packing material, as these may be hazardous to children.
- Risk of burn. Disconnect power and allow fixture to cool before changing bulb or handling fixture.

NOTE: The green ground screw is installed in its proper location. Do not Relocate.

NOTE: Please use minimum 90°C rated supply conductors.

NOTE: Specifications and dimensions subject to change without notice.

NOTE: Suitable for Dry and Damp location, Type IC.

Avertissements d'installation

- Pour réduire le risque de décès, de blessures corporelles, de dommages matériels dus à un incendie, un choc électrique, la chute de pièces, des coupures/abrasions, et autres dangers, assurez-vous de lire tous les avertissements et instructions inclus avec et sur la boîte du luminaire et toutes les étiquettes du luminaire.
- Suivez ces précautions générales avant d'installer, d'entretenir ou d'effectuer un entretien de routine sur cet équipement.
- L'installation commerciale, l'entretien et la maintenance des luminaires doivent être effectués par un électricien.
- L'installation du kit LED Retrofit nécessite une connaissance des systèmes électriques des luminaires. Si vous n'êtes pas qualifié, ne tentez pas l'installation. Contactez un électricien qualifié.
- Pour éviter d'endommager le câblage ou de l'abrasion, n'exposez pas le câblage aux bords de la tôle ou à d'autres objets pointus.
- Ne faites ni ne modifiez aucun trou ouvert dans un boîtier de câblage ou de composants électriques pendant l'installation du kit.

Avertissements

- Coupez l'alimentation électrique au niveau de la boîte à fusibles ou du disjoncteur avant de câbler le luminaire à l'alimentation électrique.
- Couper l'alimentation avant d'effectuer tout entretien.
- Vérifiez que la tension d'alimentation est correcte en la comparant aux informations de l'étiquette du luminaire.
- Toutes les connexions de câblage doivent être coiffées de connecteurs de fil approuvés UL.

Risque d'incendie ou de choc électrique. Les caractéristiques électriques de ces produits sont de 120-277 VAC, l'installateur doit déterminer s'il dispose de 120-277 V au niveau du luminaire avant l'installation.

Risque d'incendie ou de choc électrique. Installez ce kit uniquement dans les luminaires qui présentent les caractéristiques de construction et les dimensions indiquées sur les photographies et/ou les dessins.

Risque d'incendie ou de choc électrique. Le câblage et les composants électrique du luminaire risquent d'être endommagés lors du perçage pour l'installation du kit de mise à niveau pour LED. Vérifiez si le câblage et les composants sont enfermés.

Mise en garde

- Évitez l'exposition directe des yeux à la source lumineuse lorsqu'elle est allumée.
- Tenez compte des petites pièces et éliminez correctement les matériaux d'emballage, car ils peuvent être dangereux pour les enfants.
- Risque de brûlure. Débranchez l'alimentation et laissez le luminaire refroidir avant de changer l'ampoule ou de manipuler le luminaire.

REMARQUE: La vis de terre verte est installée à son emplacement approprié. Ne déménagez pas.

REMARQUE: Veuillez utiliser des conducteurs d'alimentation d'au moins 90 °C.

REMARQUE: Spécifications et dimensions sujettes à modification sans préavis.

REMARQUE: Convient aux emplacements secs et humides, type IC.

INSTALLATION INSTRUCTIONS

Retrofit Kit Components

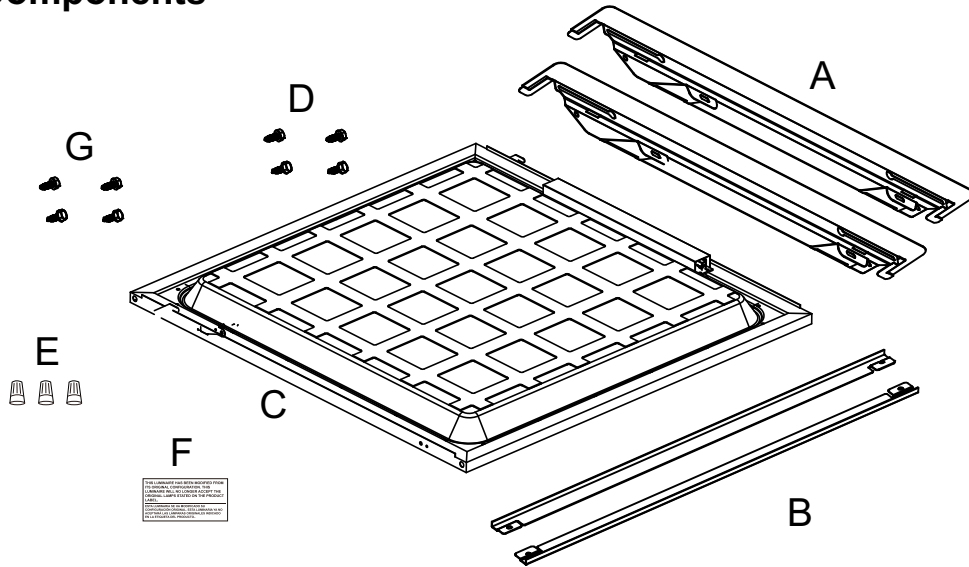

- A: End Brackets..... 2pcs
- B: Side Brackets..... 2pcs
- C: Retrofit Kit Housing..... 1pcs
- D: #8 x 1/2" Self-Taping Screws..... 4pcs
- E: Wire Caps..... 3pcs
- F: Retrofit Label..... 1pcs
- G: M4x6x8 Screws for EM..... 4pcs

NOTE: The existing fluorescent luminaires housing shall be larger than dimensions described in below table:

Housing Designation	Overall Dimensions
1' x 4'	48.0" x 11.89" x 3.07"H (1220 x 302 x 78mm H)
2' x 2'	24.0" x 23.94" x 3.07"H (610 x 608 x 78mm H)
2' x 4'	48.0" x 23.94" x 3.07"H (1220 x 608 x 78mm H)

General Wiring Diagram

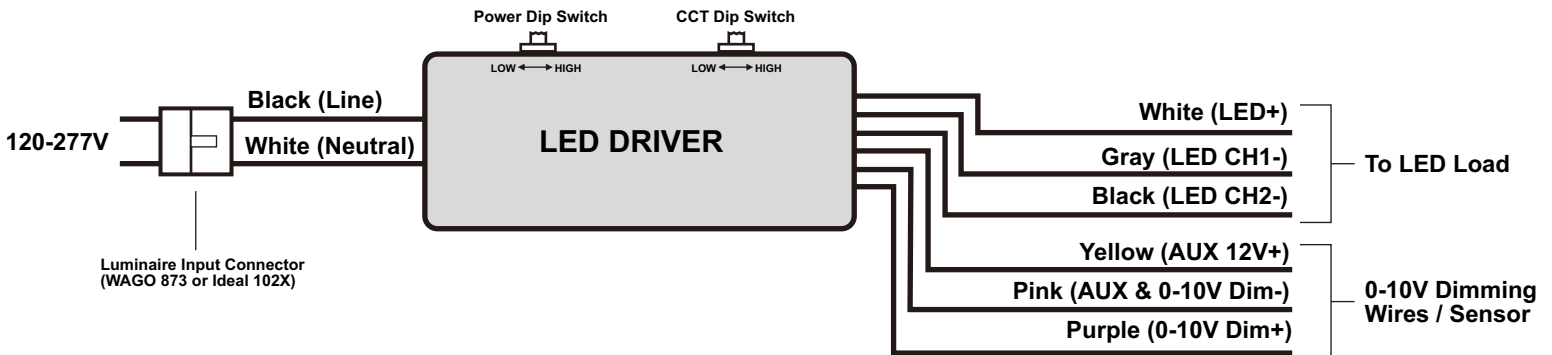

INSTALLATION INSTRUCTIONS

Field-Adjustable Wattage & CCT

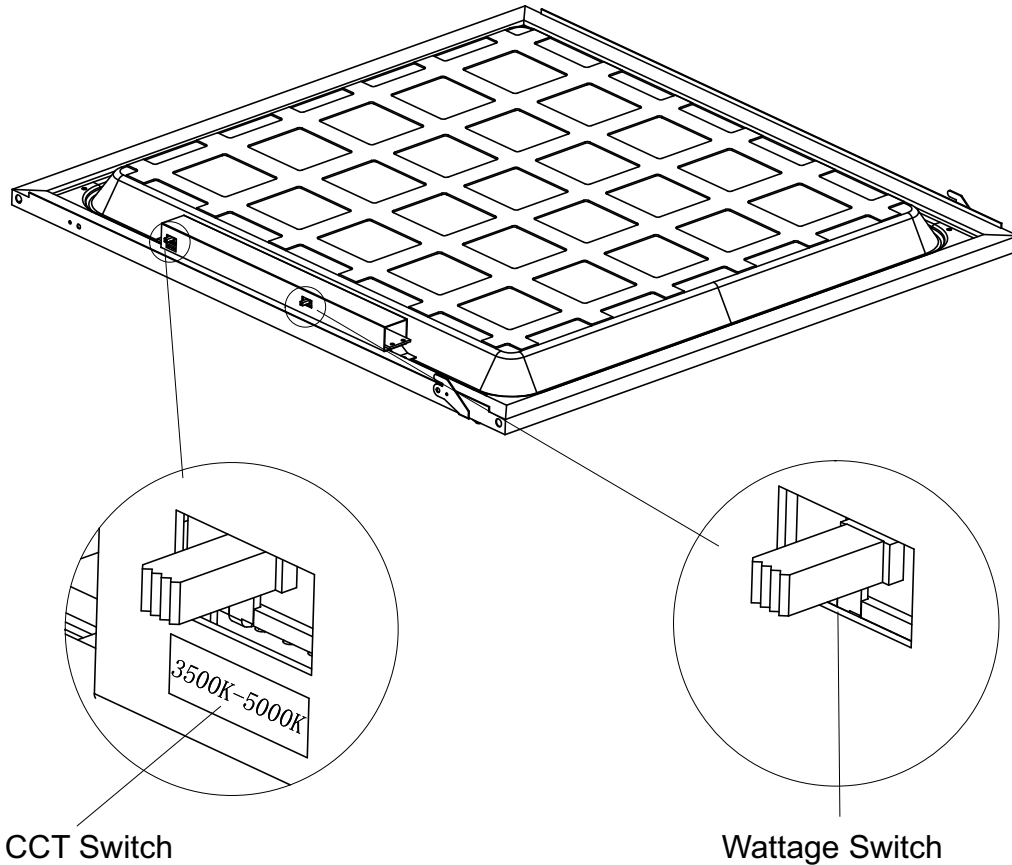

Adjustable lumen output and color temperature can be set to the desired output using the two DIP switches shown above. Each DIP switch has 3 options (Low, Medium and High) corresponding to the three available color temperatures and power levels.

1. DIP switches are located on the side of the retrofit kit housing.
2. Select a wattage and temperature by sliding each switch left or right to set the desired value. See below for available options:

Part Number	Power Level	CCT Level
VPR14-MU-25-9TW-A	18W / 22W / 25W	3500K - 5000K
VPR22-MU-25-9TW-A	18W / 22W / 25W	3500K - 5000K
VPR24-MU-36-9TW-A	23W / 30W / 36W	3500K - 5000K

* Default factory setting is the lowest CCT level (3500K) and the highest power Level (25W/36W).

Installation

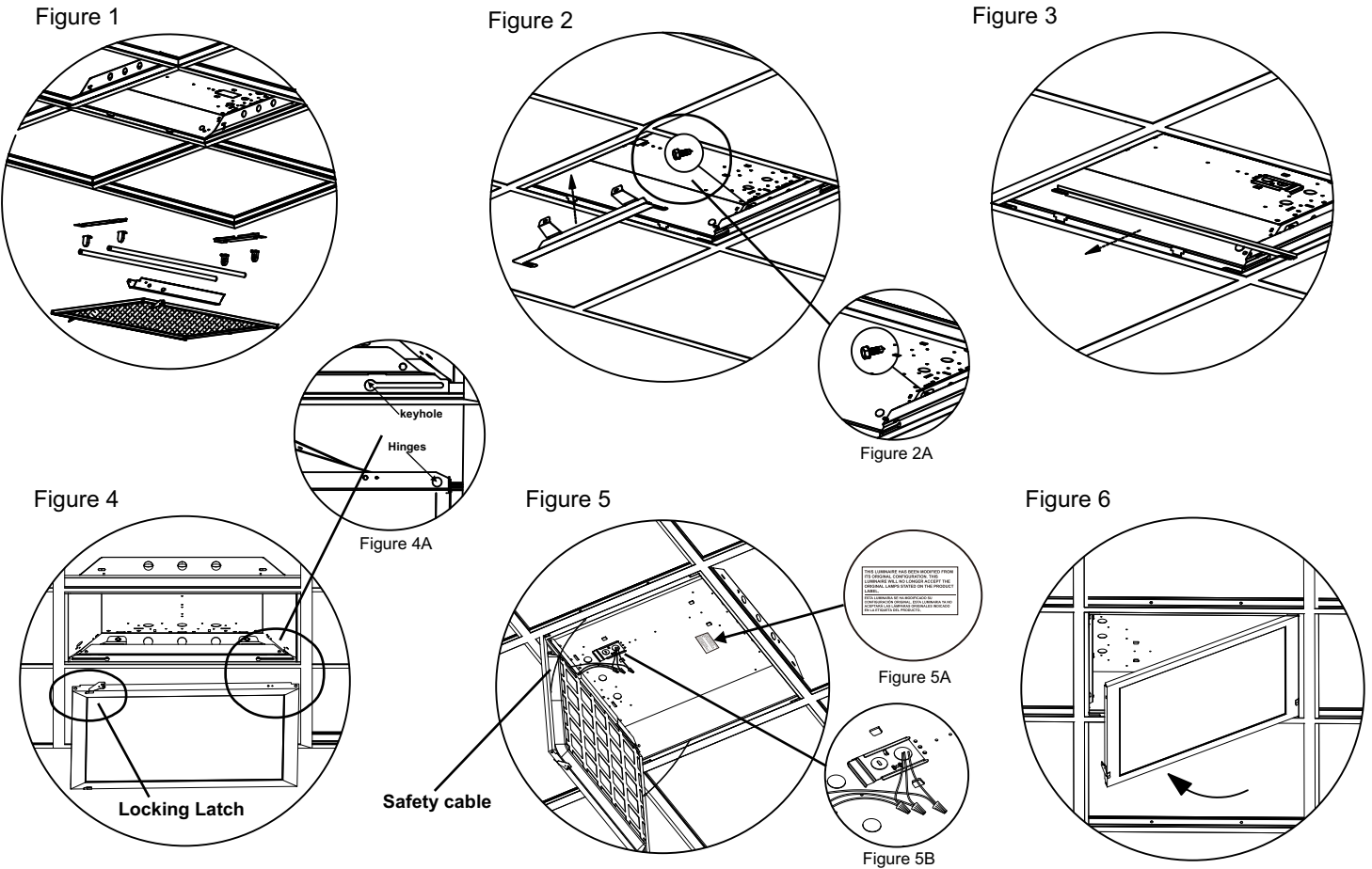

- Prior to installation, disconnect all incoming power to the fixture. Remove existing hardware (lens/lens frame, parabolic louver, reflector/ballast covers, brackets, lamps/lamp holders). Leave supply and grounding leads. (Fig. 1)
NOTE: Follow all federal and local regulations when disposing of lamps and removed components.
- Install the end brackets to each end of the existing fixture by gently lifting the fixture and placing the end brackets between the fixture and T-grid. (Fig. 2)
- If you are not pleased with the side gap between the fixture and T-grid, you may install the side brackets between the fixture and T-grid. There are two tabs to allow for placing the side brackets into the slots on the end brackets. (Fig. 3)
- Secure the end brackets to the existing fixture using the provided #8 x 1/2" self-drilling screws. (Fig. 2A)
- Place the retrofit kit housing into the slotted keyholes of the end brackets, and slide it horizontally to the end of the slots. (Fig. 4 & 4A)
- Hook the safety cables onto the holes positioned on the end brackets. (Fig. 5)
- Use the provided wire caps to connect the wire leads of the retrofit kit housing to the main power leads. (Black-Live, White-Neutral, Green-Grounding) (Fig. 5B)
- Place the provided Retrofit Label on the original luminaire housing in a readily visible location for anyone attempting to service the luminaire. (Fig. 5-A)
- Secure the retrofit kit housing by locking the latches onto the end brackets. (Fig. 6)

INSTALLATION INSTRUCTIONS

Additional Accessories (Sold Separately)

Emergency Battery Back-up Kit:

Part Number: **VPREMKIT** for 2'x2' and 2'x4';
VPREMKIT-14 for 1'x4'

- 4W Constant Power Emergency Back-up
- 500lm
- 90 min.Runtime.
- Includes: Bracket, EM Driver, and Wall Plate



Installation: EM Bracket

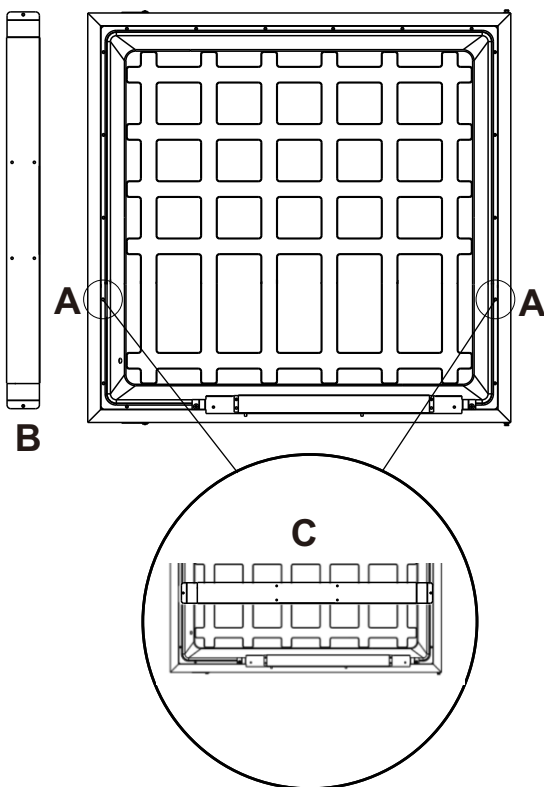

Step 1

Locate the bracket mounting panel screws on the back of the fixture(A).

Step 2

Remove the panel housing screws, and place EM bracket(B) over the mounting holes.

Step 3

Use panel housing screws to mount EM bracket on fixture(C).

Installation: EM Driver

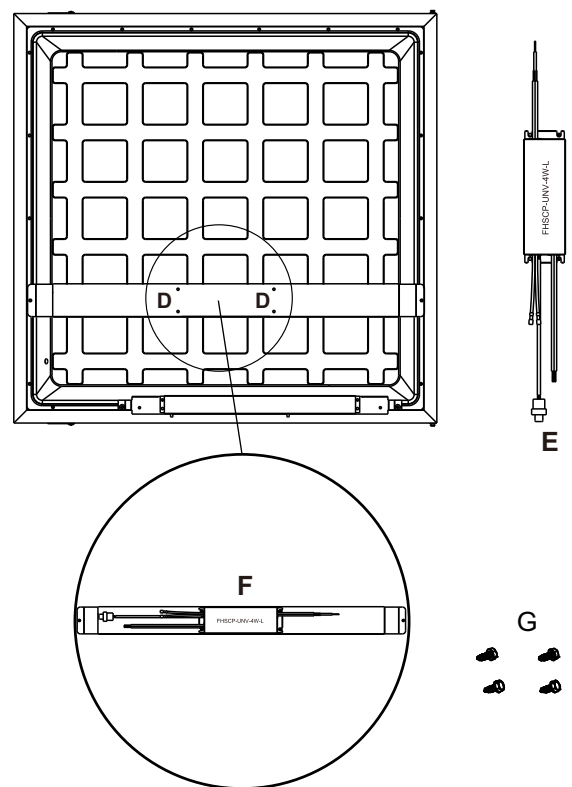

Step 4

Locate the driver mounting holes on the back of the fixture EM bracket(D).

Step 5

Take EM driver(E) and place over mounting holes.

Step 6

Take M4x6x8 screws(G) provided in the kit.

Step 7

Mount the EM driver to the EM bracket(F).

Step 8

Wire EM driver to retrofit kit per the diagrams on page 7.

INSTALLATION INSTRUCTIONS

Emergency Battery Back-up Kit: VPREMKIT cont.

Wall Plate: FHSWLPWH

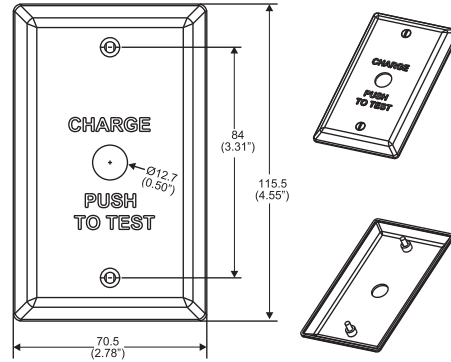

Wall plate and screw color:
white with black lettering

1. "Charge push to Test" plate
2. (2) 6-32 x 1/2" LG mounting screws

Emergency Wiring Diagrams

Wiring Diagram 1: 3500K Emergency Output

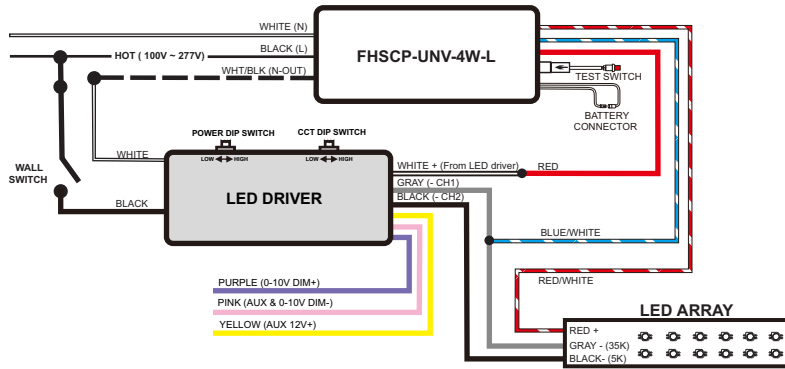

Wiring Diagram 2: 5000K Emergency Output

