

LED RETROFIT SOLUTIONS FOR:
HOSPITALS &
ASSISTED LIVING
FACILITIES



FULHAM
Harness the Horsepower



PANELS

TROFFERS



Retrofit Kits

PANELS & TROFFERS



2x4: VPR-24-MU-36-9TW-A

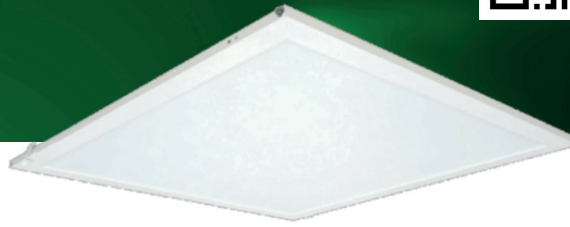

2x2: VPR-22-MU-25-9TW-A



1x4: VTR-14-MU-30-9TW-A



2x4: VTR-24-MU-45-9TW-A



CCT & Power Switchable - 3-wattages options for each panel and 3500K, 4000K, and 5000K switchable



Fulham Easy Emergency – Panels are prepared for emergency battery back-up with quick mount solution



Troffer version is Sensor Capable – PIR and daylight sensor capable



0-10V Dimmable, 120-277VAC Input, and Easy to Install – Ready for many applications and low cost



2x2 VTR-22-MU-30-9TW-A



1x4: VPR-14-MU-25-9TW-A

	VPR-14-MU-25-9TW-A			VPR-22-MU-25-9TW-A			VPR-24-MU-36-9TW-A			VTR-14-MU-30-9TW-A			VTR-22-MU-30-9TW-A			VTR-24-MU-45-9TW-A		
Shape	1X4 Panel			2x2 Panel			2x4 Panel			1X4 Troffer			2x2 Troffer			2x4 Troffer		
Input Power	18W	22W	25W	18W	22W	25W	23W	30W	36W	20W	25W	30W	20W	25W	30W	34W	38W	45W
Lumen Output@ 4000K	2376	2838	3150	2376	2838	3150	3036	3870	4536	2640	3225	3780	2640	3225	3750	4488	4902	5670
Efficacy @4000K	132 Lm/W	129 Lm/W	126 Lm/W	132 Lm/W	129 Lm/W	126 Lm/W	132 Lm/W	129 Lm/W	126 Lm/W	132 Lm/W	129 Lm/W	126 Lm/W	132 Lm/W	129 Lm/W	126 Lm/W	132 Lm/W	129 Lm/W	126 Lm/W
CCT & CRI	3500K, 4000K, 5000K 3-level selectable; CRI 90 Standard																	
Dimensions	47.9"L x 11.9"W x 2.2"H			23.8"L x 23.8"W x 2.2"H			47.8"L x 23.8"W x 2.2"H			47.9"L x 11.9"W x 3.09"H			23.8"L x 23.8"W x 3.09"H			47.8"L x 23.8"W x 3.09"H		
Certificate	Component: cURus Retrofit Kit: cULus Classified DLC 5.1 Premium CEC Title 24 JA10 RoHS compliant																	

Warranty

5 Years @ Max. Tc from the date of manufacture



Panel & Troffer LED Retrofit Kit

Key Benefits for Health Care Applications



No Need to Open the Plenum/Ceiling:

- Retrofit kits can be installed directly into existing fixture housings
- Maintains the integrity of the plenum, avoiding potential contamination and compliance issues
- Less labor to install, faster, and lower risk of environmental contamination



Minimal Service Disruptions:

- Installation can be performed by maintenance personnel
- No need for contractor crews, reducing the need to close areas of the facility for repairs
- Ensures continuous operation of healthcare services



CCT and Power Selectable Efficient Lighting:

- Three selectable power levels per model
- Selectable color temperatures: 3500K, 4000K and 5000K
- High efficiency with DLC 5.1 Premium Listing
- Long lifespan: L70 > 60,000 hours and L90 > 36,000 hours



Easy Installation & Cost-Effective Solution:

- As easy as swapping a ballast, so maintenance staff could perform installations
- Energy-efficient design lowers operational costs over time



Wireless or Smart Control Options Available:

- Hyper intelligent quick-connect wireless control options are available. Simply pop-in a control module and you have wireless control without the work
- Reduce labor for control installation with fast wireless sensors that provide presence/absence detection, daylight harvesting, dimming and output trims

SENSOR OPTION & REMOTE



EMERGENCY BATTERY PACK OPTION



PRE-TAPPED EMERGENCY MOUNTING POINTS

INSTALLATION INSTRUCTIONS

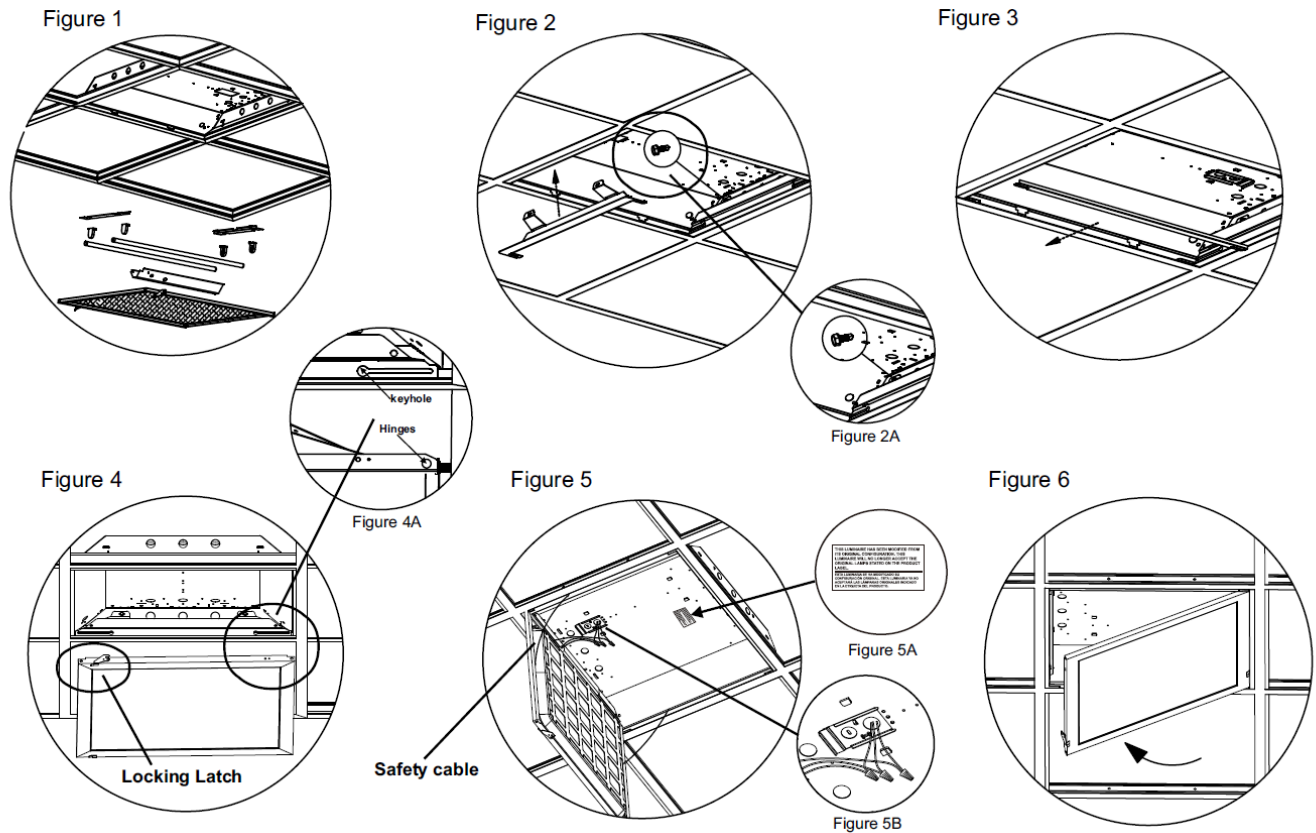

Why Choose Fulham?

Fulham's LED Luminaire Retrofit Kits are designed with the unique needs of healthcare facilities in mind. Our solutions ensure a seamless upgrade process, maintaining the highest standards of safety and efficiency. Trust Fulham to provide reliable, high-quality lighting solutions that support the critical operations of your healthcare facility.